



Set sail to
Splendour...





This brochure does not form part of a legal offer. Furniture and fixtures are indicative only. All dimensions are in mm. Information contained in this Brochure is subject to change without notice. Slight variations on area may occur.



Welcome Happiness

Blu Rain Luxury Villa Project is a fresh initiative of world-known Tulsi Developers India Pvt Ltd in the God's own country. Set on the banks of Periyar River at Aluva, the beautiful slice of land known for its eternal charm Blu Rain brings you a lifestyle so serene, so splendid and so inviting. Here you are going to re-discover the pleasure of living on the refreshing riverfront.







Refreshing Riverfront

To enjoy a luxurious happy life in a resort like ambience all filled with every modern amenity, Blu Rain opens its gate for you. Sprawling across 5 acres of land, which blesses you with a panoramic view of the cool blue waves of Periyar River, Blu Rain is a man-made paradise. Blu Rain will get you an unearthly elegant living experience in an expanse of boundless greenery surrounded by serenity.



This brochure does not form part of a legal offer. Furniture and fixtures are indicative only. All dimensions are in mm. Information contained in this Brochure is subject to change without notice. Slight variations on area may occur.



Type - A

Total Area : 3313 sq.ft

First Floor : 1298.77 sq.ft

Ground Floor : 2014.16 sq.ft





Classy Environs

The ultra modern super luxury villas belong to Blu Rain beckon those who seek exceptional levels of modern comforts. This quality designed dream home has practical space, superb detail and quality fittings. It's where you will restore energy and harmony, refresh and invigorate, relax and unwind. The magnificent, master built villa has evolved from innovative thinking to an expression of pure luxury.



This brochure does not form part of a legal offer. Furniture and fixtures are indicative only. All dimensions are in mm. Information contained in this Brochure is subject to change without notice. Slight variations on area may occur.



This brochure does not form part of a legal offer. Furniture and fixtures are indicative only. All dimensions are in mm. Information contained in this brochure is subject to change without notice. Slight variations in color may occur.



Prestigious Lifestyle

Upon entering your Blu Rain home, you'll feel as though you have entered a royal retreat midst plenty of seclusion and serenity. Here the ornate doors lead you to a private, yet lavish oasis with: wide roads with paved tiles, vast swimming pool, highly sophisticated clubhouse, fullfledged health club, barbeque centre and many more superb facilities, you always craved for.



This brochure does not form part of a legal offer. Furniture and fixtures are indicative only. All dimensions are in mm. Information contained in this Brochure is subject to change without notice. Slight variations on site may occur.



Type - B

Total Area : 3032.07 sq.ft

First Floor : 1213.09 sq.ft

Ground Floor : 1767.98 sq.ft



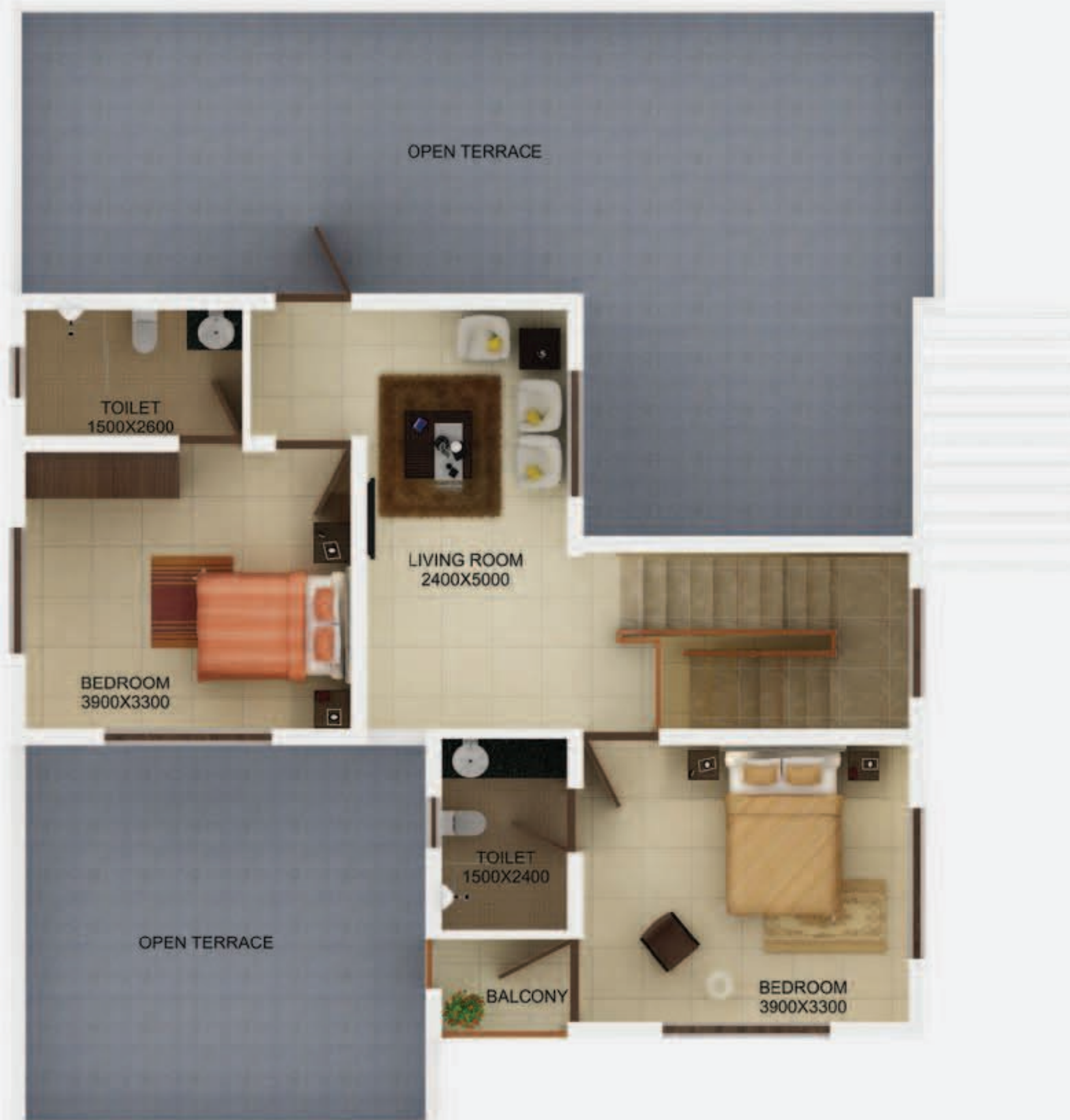

Type - C

Total Area : 2506 sq.ft

First Floor : 799.91 sq.ft

Ground Floor : 1705.61 sq.ft



Type - D

Total Area : 2351 sq.ft
First Floor : 925.91 sq.ft
Ground Floor : 1425.75 sq.ft

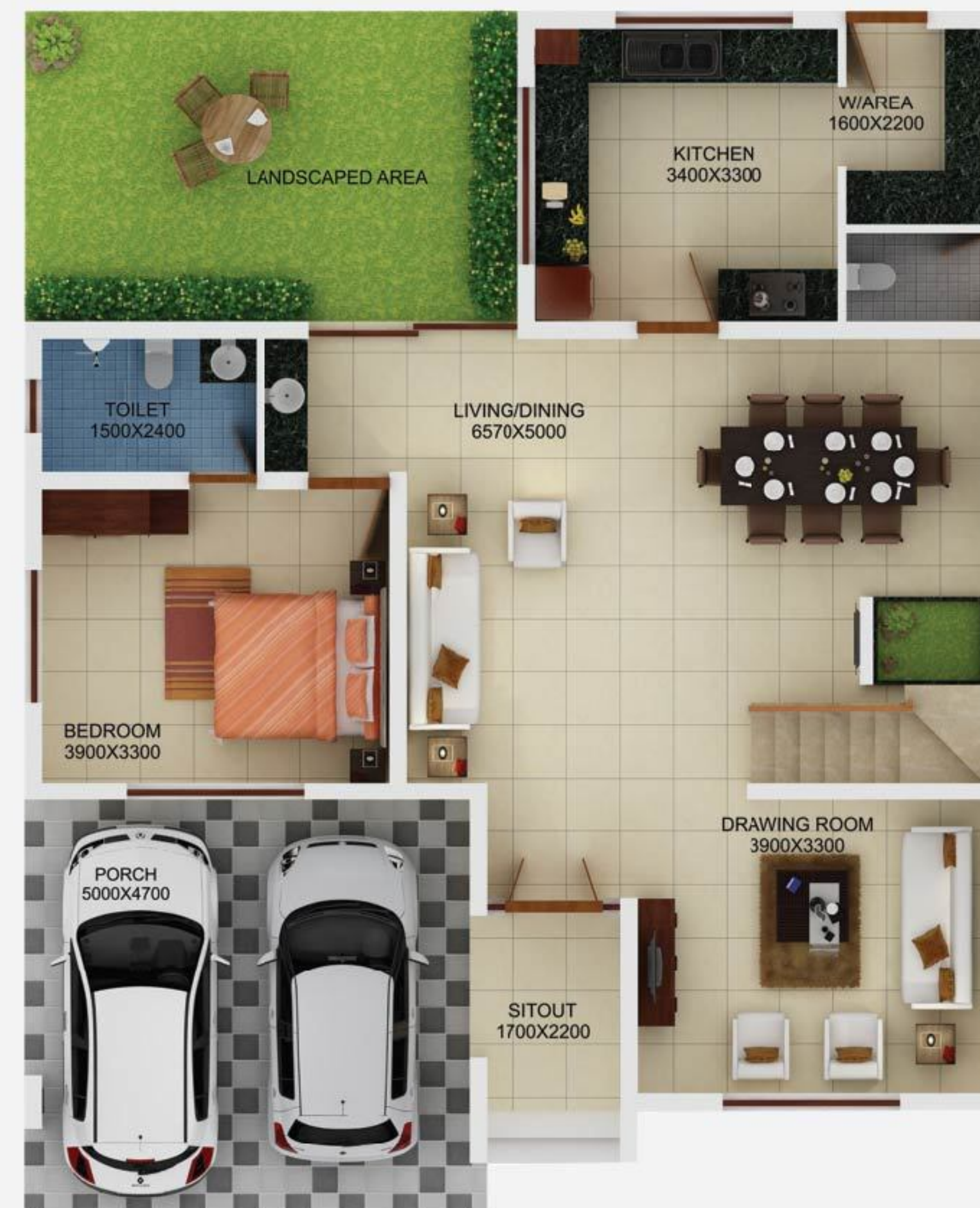



Royal Relaxation

Nestled in the tranquil surroundings, Blu Rain Clubhouse boasts of state - of - the - art facilities offering utmost relaxation and ultimate enjoyment. Sitting among the landscaped gardens and adjoining swimming pool, the Clubhouse offers a variety of excellent facilities. To improve your fitness levels and get rid of those extra calories, you can also find a high-end health club along with Basketball Court, Cricket Net, etc. on the Blu Rain premises. Perfect places to energise and revitalise or to relax and unwind.



This brochure does not form part of a legal offer. Furniture and fixtures are indicative only. All dimensions are in mm. Information contained in this Brochure is subject to change without notice. Slight variations on site may occur.



Spectacular Interiors

The open floor plan with high ceilings, the large living room, ample dining room, all add to your Blu Rain home's spaciousness feel. The abundance of gorgeous windows, which look out to the mesmerizing scenery around always gets you the experience of living in a resort like home. Enormous bedrooms with plenty of closet space, designer appointed baths, generous kitchen space, like everything make these luxury villas complete.



This brochure does not form part of a legal offer. Furniture and fixtures are indicative only. All dimensions are in mm. Information contained in this Brochure is subject to change without notice. Slight variations on site may occur.



Villa Types

Type A : 3313 sq.ft

Type B : 3032 sq.ft

Type C : 2506 sq.ft

Type D : 2351 sq.ft

Type E : 1727 sq.ft



This brochure does not form part of a legal offer. Furniture and fixtures are indicative only. All dimensions are in mm. Information contained in this Brochure is subject to change without notice. Slight variations in area may occur.



Unique Amenities

Exquisite Landscaping and Garden with Palms | Cascading
Water Body Clubhouse | Swimming Pool with Baby Pool |
Barbeque Center Jacuzzi & Steam Bath | Multi Gym | Round
the Clock CCTV Security System | Generator Back-up |
Intercom | Broadband Connectivity Ornamental Street Light
| Basket Ball Half Court | Cricket Net Practice Area |
Billiards Room | Table Tennis | Association Room |
Servant's & Driver's Common Toilet | Extensive Compund
Wall with Security Cabin | Internal Road with Paved Tiles |
Children's Play Area | Wide Water Frontage | Home Theatre
| Library



This brochure does not form part of a legal offer. Furniture and fixtures are indicative only. All dimensions are in mm. Information contained in this brochure is subject to change without notice. Slight variations on area may occur.

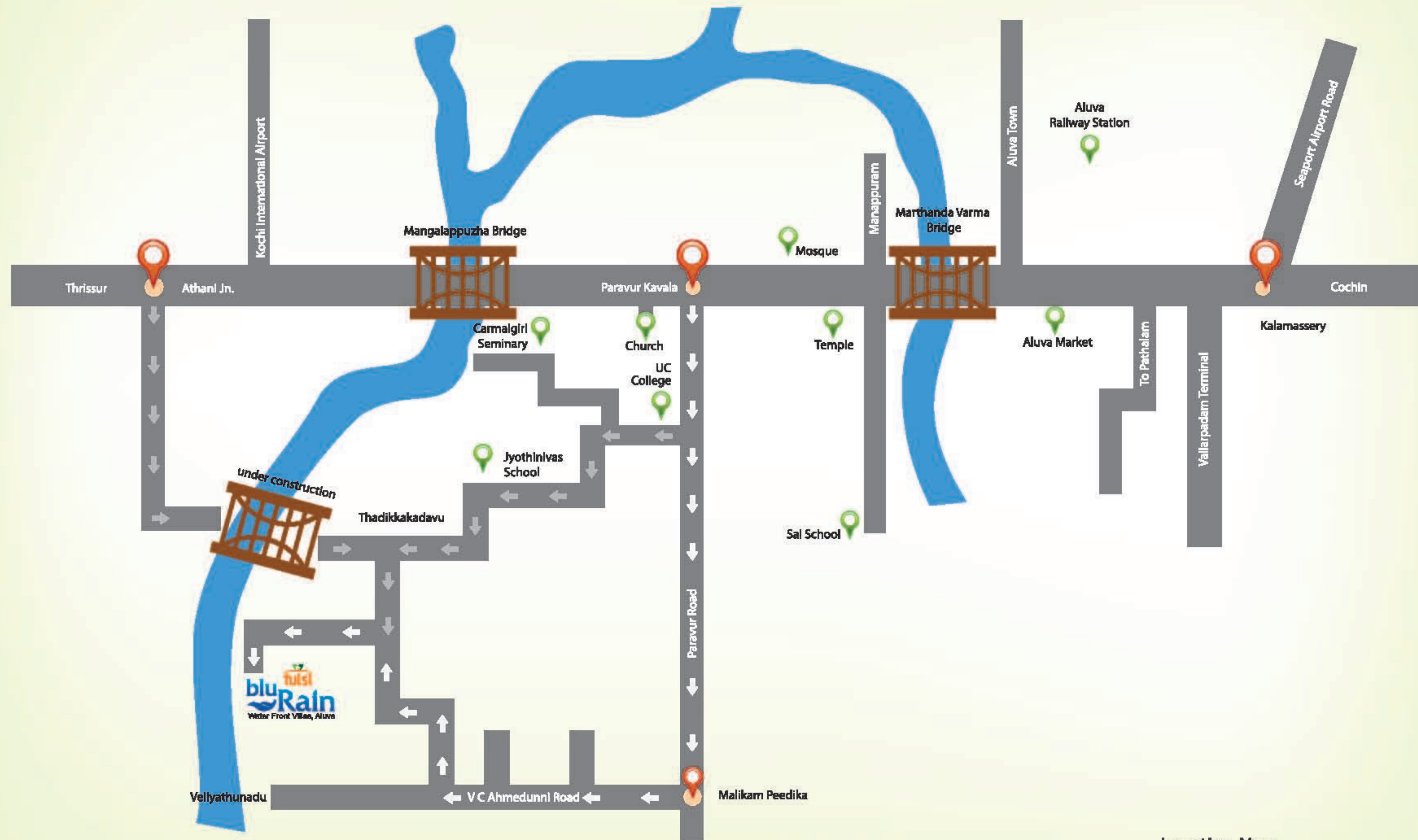

Location Map



Ideal Location

At Aluva, the serene pace of life and close proximity to major 5 transit service points including International Airport, Railway Station, K.S.R.T.C Bus Station, Proposed Metro Railway Station and Tourism Waterway has heightened Blu Rain's appeal as the perfect location to live. Moreover Aluva is a pleasant mix of rural and urban, of progress and natural environment, of close-knit community and optional seclusion.



This brochure does not form part of a legal offer. Furniture and fixtures are indicative only. All dimensions are in mm. Information contained in this Brochure is subject to change without notice. Slight variations on area may occur.





Intelligent Investment

When you become the proud owner of a Blu Rain Villa, it is more than an investment in luxury lifestyle. Apart from luxurious living, Blu Rain Villas are also a sound investment opportunity for investors who are looking for a safe investment with potentials of high returns. With high-speed metropolitan developments in Cochin and its suburbs, the property prices at Aluva are all set to soar and Blu Rain Villas are waiting to offer you abundant gains.



- Return on investment
- Timely Completion
- Quality Policy



This brochure does not form part of a legal offer. Furniture and fixtures are indicative only. All dimensions are in mm. Information contained in this Brochure is subject to change without notice. Slight variations on area may occur.

SPECIFICATION

Foundation	: Recommended by the Architect.	
Structure	: Wall with red brick.	
Flooring	: Mirror polished vitrified tile for flooring for entire area without master bed room. Laminated wooden flooring for master bedroom . Living room , dining room , f.living , Sitout - 1m X 1m/0.8m X 1.2m vitrified tile. Other portion 60 x 60 vitrified tile – RAK/Equivalent.	
Toilet	: Superior quality antiskid vitrified tile for flooring, superior quality vitrified tile for wall up to ceiling height – 60 X 60 Kajaria / Equivalent.	
Bathroom Fittings	: Sanitary Fittings Master Bed room : W/C wall hanging & wash basin table top Duravit or Equivalent. Other Bedrooms : W/C wall hanging & wash basin table top Duravit or Equivalent. Servants Toilet : Cera/Parryware/Equivalent. CP Fittings : All Bathrooms: Jaquar/Artize/Hansgrohe/Equivalent. Shower Area : Provision for Glass Partition.	
Stair Case	: Vitrified tile for treads and risers and stainless steel with wood work handrail.	
Painting	: Exterior and Interior putty with plastic emulsion finishing.	
Doors	: Well finished hard wood with paint finishing as per Archiectural drawing. UPVC sliding glass door for river front villa in upstairs.	
Windows	: Hard wood windows with paint finishing with MS grill as per Architectural drawing.	
Electrical Items	: All wires are Finolex /Equivalent and all switches are Legrand /Equivalent. Provision for Telephone, Cable TV, A/C point for entire area without kitchen and work area.	
Generator	: Lights, fans & TV point in entire area ,A/C point in master bed room.	

Call: | +91 90203 00200 , +97 15252 21141

www.tulsidevelopers.org



TULSI DEVELOPERS INDIA PVT.LTD.

VIII/522B, 139, Mavelipuram, Near Sunrise Hospital, Seaport - Airport Road, Kakkanad, Kochi - 30.

www.tulsidevelopers.org, e-mail: enquiry@tulsidevelopers.org